

# AIR MANAGEMENT IN SENSITIVE AREAS - TROX SUPPLIES SAFE VENTILATION SYSTEMS FOR LABS

[□ back to the overview](#)

---

<b>date</b>	<b>rubric</b>
15.03.2017	products

At ISH 2017, TROX presents under the theme of 'The TROX Principle' once again a range of innovative and optimised systems, units and components.

## NETWORKED WORLDS – NETWORKED SYSTEMS

Increasing urbanisation is accompanied by a need to constantly adapt buildings to changing use. This is why TROX has developed integrated ventilation and air conditioning systems which respond to changing requirements in real time. They ensure the provision of the required air quality on demand as well as maximum building safety, and then independent of the building type or usage.

## WORKING SAFELY

Labs and clean rooms pose the greatest challenge to air management systems. Where aggressive substances are being handled, control systems have to respond quickly. Sensitive areas are separated from other areas by different pressure levels, i.e. negative or positive pressure. It is important that these different conditions are always maintained. Monitoring is a must.

LABCONTROL by TROX has long proven to be a reliable control system for highly sensitive areas. It is found in many places where aggressive substances are handled and where consequently very short response times and the perfect interaction of all components are critical. At the centre of LABCONTROL is EASYLAB, which recognises all the installed components automatically and which provides connections for various bus systems. EASYLAB is a very flexible system so that changes of use or expansions do not necessarily require re-commissioning. By integrating the system with the X-AIRCONTROL single room control system it is possible to control temperature, humidity and air quality. For maximum comfort.

TROX also *shows VAV terminal units of Type TVLK*, which are combined with the EASYLAB TCU3 controller to control volume flow rates in fume cupboards with contaminated extract air.

The VAV terminal units are manufactured using advanced injection moulding technology. Volume flow rates are measured either with adjustable nozzles or with a bluff body. If required, the effective pressure measuring devices can be removed and cleaned while the controller remains in place.

Although the VAV terminal unit is only 400 mm long, it works perfectly even with unfavourable upstream conditions. What is more, all parts in the airflow are made of resistant polypropylene.

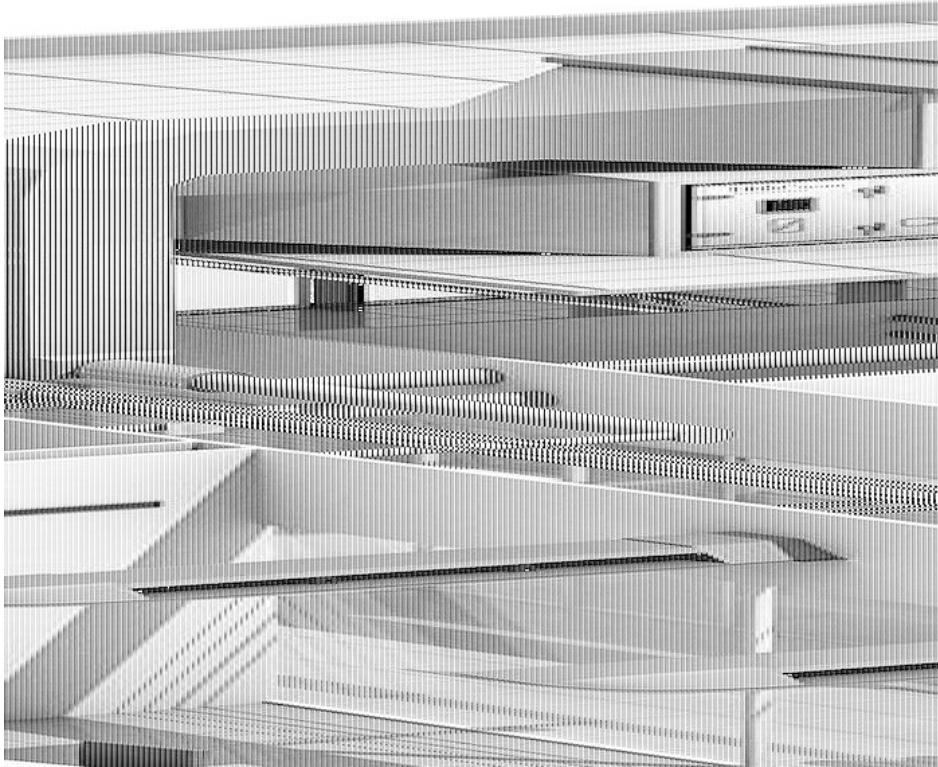

*LABCONTROL is a control system especially for sensitive areas such as labs and clean rooms.*

Visit TROX at ISH (hall 11.0, booth B51) to see these and many other innovations. More information and technical details of the systems and products shown can be found at [www.trox.de/PR\\_ISH2017](http://www.trox.de/PR_ISH2017)

Download [Press Release](#)  
Download [Photograph](#)

TROX is leading in the development, manufacture and sale of components, units and systems for the ventilation and air conditioning of rooms. With 27 subsidiary companies in 27 countries on 5 continents, 14 production facilities, and importers and representatives, TROX is present in over 70 countries. Founded in 1951, global market leader TROX, whose international head office is in Germany, generated in 2016 with a total of 3,700 employees around the globe revenues of nearly €500 million.

For further information or should you have any questions about TROX, please contact:

Christine Roßkothen  
Corporate Marketing  
Voice: +49 (0) 2845 202464  
Fax: +49 (0) 2845 202587  
[c.rosskothen@trox.de](mailto:c.rosskothen@trox.de)  
[www.troxtechnik.com](http://www.troxtechnik.com)