

CUBE X2

The new generation – optimised for solutions
up to 25,000 m³/h



TROX[®] TECHNIK
The art of handling air



**GERMAN
DESIGN
AWARD
WINNER
2020**

The X2 is available in white and charcoal black

The range also includes a weatherproof version for outdoor installation. Each unit is configured, according to your individual requirements, and all components are perfectly matched to one another. You can even design it yourself quickly and easily on our secure website – including calculating the lifecycle costs.



Pre-configured X2 compact – the fast, efficient solution

The compact, pre-configured X-CUBE X2 compact, available in 12 sizes, is used for volume flow rates of 600 to 15,000 m³/h (0.17 to 4.2 m³/s). It is not just their compact nature that sets these units apart, but also their rapid availability and excellent efficiency.

This type also features the latest EC fan technology with peak efficiencies of up to 75%. Heat recovery takes place by means of rotary heat exchanger or counter flow plate heat exchanger.



Also available in charcoal black

The functionality can be expanded

at any time. So, for example, heaters with integrated frost protection, cooling coils, DX cooling coils, change-over systems and many other components can be integrated directly or retrofitted as external modules. The compact unit is also available in white or charcoal black.



Integrated inspection window

► TROX X-CUBE X2 – the next generation ►►

Optimised for small and medium volume flow rates

New series expands the X-CUBE range

The X-CUBE units from TROX set new benchmarks in terms of flexibility, hygiene, energy efficiency, ease of maintenance and connectivity. X-CUBE X2 is a newly developed series from TROX, designed specifically to extend the X-CUBE range. The new generation is optimised for small to medium volume flow rates and offers tried-and-tested TROX system quality with sophisticated features.



Revolutionary system



7" touchscreen control



Innovative panel latching

Highlights at a glance

- Freely configurable units and pre-configured compact solutions
- Cutting-edge design with colour options
- TROX Vibration Damper base frame (optional) – no need for expensive insulation on site
- High mechanical strength unit base
- Light-weight for ease of transport and installation
- Optimal hygiene properties thanks to smooth internal surfaces and small clearances
- Innovative, robust and flexible locking solution for doors and inspection / access panels
- Intuitive operation and integration into building management systems using the control software X-CUBE control 2.0

Freely configurable X2 – the comprehensive solution

The units of series X-CUBE X2 are the ideal solution for volume flow rates of 600 to 25,000 m³/h (0.17 to 6.9 m³/s). These units are freely configurable and can be used for all air treatment processes.

The X-CUBE X2 is available in 25 sizes, and can be equipped with a rotary heat exchanger, a plate heat exchanger or a run-around coil system.

*X-CUBE X2
Volume flow rates,
sizes and the resulting
velocity class
as per EN 13053
(intermediate sizes
not shown)*

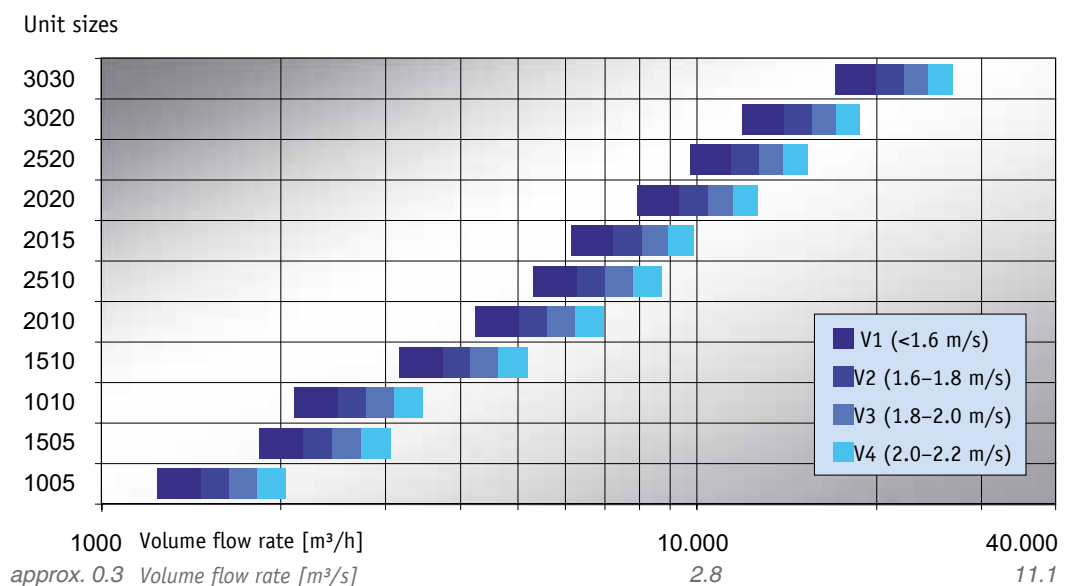

► X-CUBE Configurator ►►

Web-based configuration software makes lifecycle costs transparent

All you need to design your X-CUBE X2 to your requirements and determine consumption over the entire lifecycle is a web browser. The web-based X-CUBE Configurator lets you configure your air handling unit in a simple manner based on your parameters.

You specify the type of installation and heat recovery and enter the key sizing points (volume flow rate, external pressure drop, air temperatures, humidity), the desired air filtration and the required heating or cooling capacity. In just a few seconds, the system will determine the best possible unit design and project the lifecycle costs for the specific location.

The investment, maintenance and energy costs are itemised in detail and presented in an easy-to-understand manner. You can save your projects to compare design variants at your convenience.

The wide range of output options provides support for further work. Drawings, data sheets and specification texts are produced and available to download. It is possible to create BIM files using the TROX CAD browser.

The CO₂ footprint of your ventilation and air conditioning system

We are continually working to develop the range and add exciting functions. It will soon be possible to determine not only the lifecycle costs but also the CO₂ footprint of your design variants during operation.

This will allow you to factor in ambitious climate protection targets into your design in advance.

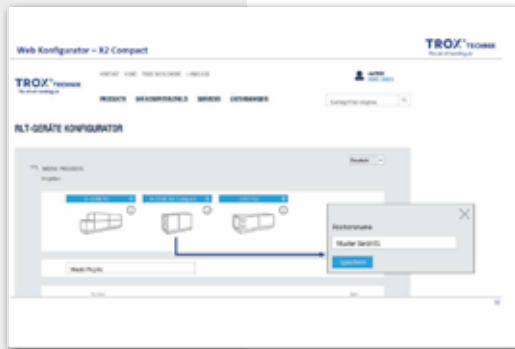

Simple design procedure

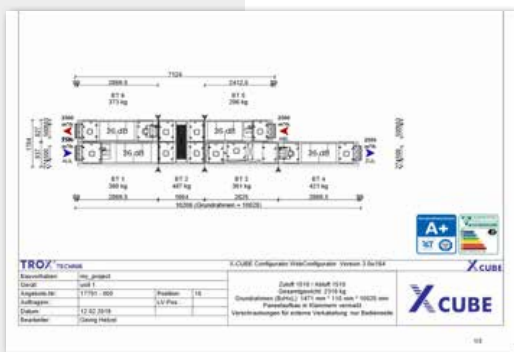

Wide range of output options



The X-CUBE Configurator can be used to calculate lifecycle costs. It works for any location.

X CUBE X2



TROX filters of energy efficiency class A (MFI) and A+ (MFI ECO) with high dust holding capacity and minimal initial pressure loss for low power consumption.



The replaceable EPDM continuous seal ensures excellent leak-tightness around the inspection access doors.

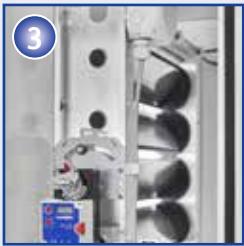

TROX multileaf dampers with aluminium hollow blades to promote flow, configurable up to leakage class 4 in accordance with EN 1751.



The highly efficient EC fans without impeller housing achieve efficiencies of up to 75% even under partial load.

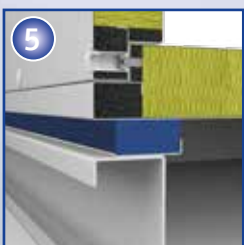

The casing design is insulated against noise and has excellent thermal properties.



Optionally with TROX Vibration Damper base frame thanks to the innovative acoustic base frame (blue) made from high-quality Sylomer®.



► Details that impress ►►

The inspection access panels are fastened at both sides. They can be opened to the left or right using the universal key, and can also be removed completely.



Intuitive operating concept on high-performance 7" touchscreen display.

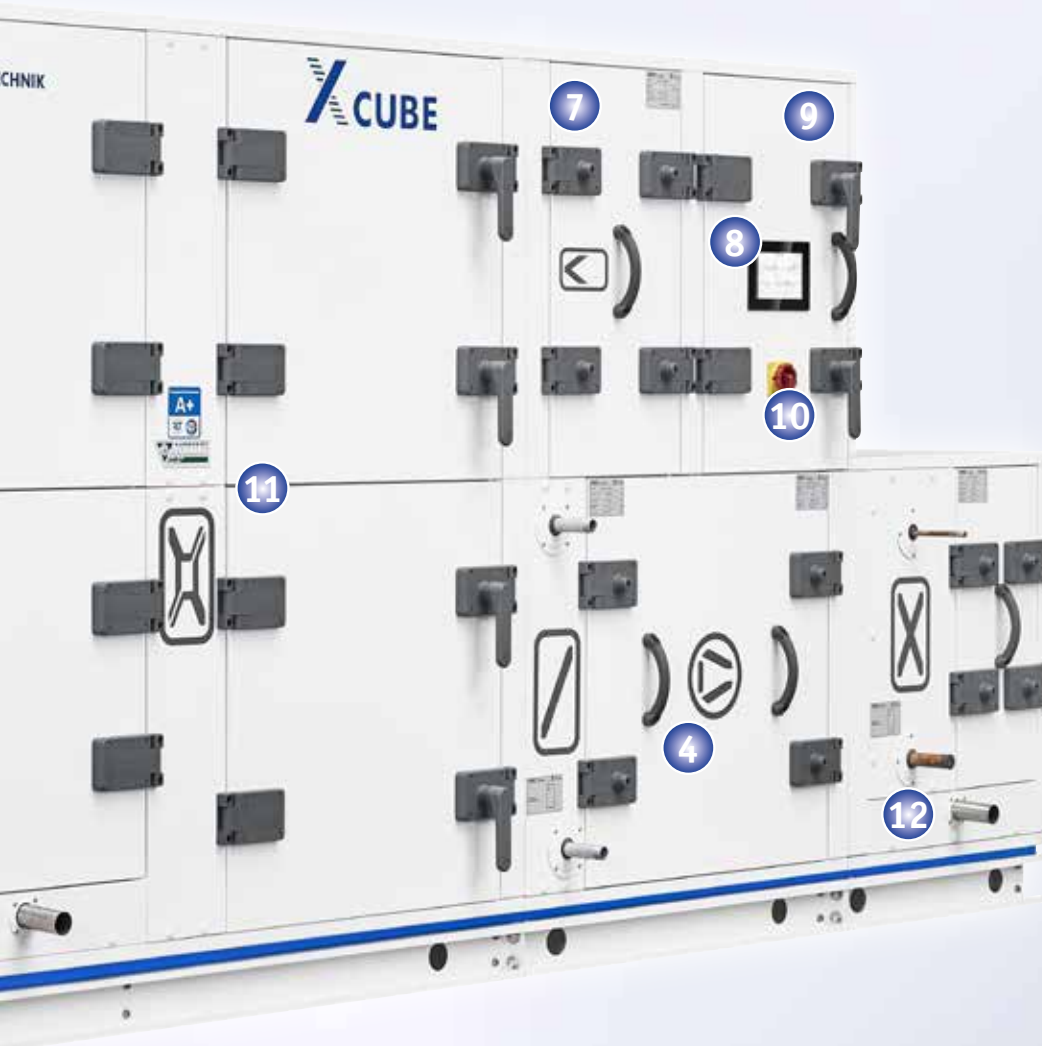

Versatile sensor system for measuring temperature and pressure differences ensures demand-based control.



The modular, expandable controls on industrial PC basis can communicate with virtually all building management systems via BACnet and Modbus.

The electronics are accommodated in an easily accessible, ventilated switch cabinet.

Heat transfer depending on design, optionally via

- Rotary heat exchanger (optionally with storage mass with hygroscopic coating)
- Plate heat exchanger
- Run-around coil system



Excellent hygiene thanks to stainless steel condensate drip tray, sloping on all sides, fitted beneath the heat exchanger for cooling and dehumidification.



► X-CUBE control 2.0 ►►

Universal connectivity and IoT-compatible

The X-CUBE X2 is equipped with the new X-CUBE control 2.0. The unit can be operated using a high-performance touchscreen, and can be connected to the TROX systems X-AIRCONTROL, TROXNETCOM and X-TAIRMINAL.

The monitoring functions of X-CUBE control 2.0 with automatic status messages make for convenient system control around the clock.

The X-CUBE X2 is seamlessly integrated into the central building management system via BACnet IP or Modbus TCP/IP. Thanks to its universal connectivity, the output of the air handling unit can be controlled based on demand. This combines top-class comfort with outstanding energy savings.

Modular and equipped for the future

The controls are of modular design. This provides the utmost flexibility at low cost and allows for expansion at a later date.

TROX Cloud Connectivity from X-CUBE control 2.0 makes the X-CUBE X2 IoT-compatible. In the future, this will open up important potential for cutting costs, for example through remote maintenance and predictive maintenance.



Die X-CUBE control 2.0 user interface

Tested to EN 1886

- Thermal transmittance T2
- Thermal bridging TB2
- Casing leakage L1
- Mechanical strength D1





 **CUBE X2**

TROX[®] TECHNIK
The art of handling air

TROX GmbH
Heinrich-Trox-Platz
47504 Neukirchen-Vluyn, Germany
Tel. +49(0)2845 2020
trox@trox.de

www.troxtechnik.com